

# SKIN ANALYSER 3D



## Transform Your Clinic with Skin Analyser 3D

Elevate your consultations and improve patient outcomes with the advanced Skin Analyser 3D. Its cutting-edge technology ensures accurate, engaging diagnostics, helping you deliver tailored treatments with confidence

Contact us

Shop 23A Mount Annan Market place 11-13 main st,  
Mount Annan 2567

+61 489 904212; +61 2 8526 4838



Learn more about Aesthetic Consults  
information @aesthetic\_consults  
official account





At **Aesthetics Consults**, we bring you the cutting-edge **Skin Analyser 3D**, a revolutionary diagnostic device that uses **3D imaging and AI-powered technology** to provide in-depth insights into your clients' skin. With **8-spectrum imaging** and advanced analysis tools, this device enables clinics to deliver highly customised treatments with precision and confidence

### Why Choose Skin Analyser 3D for Your Clinic?

Skin Analyser 3D transforms the way you approach skin diagnostics, making your consultations more accurate, engaging, and professional

#### Key Features

**3D Imaging Technology:** Creates a detailed 3D model of the face for accurate assessments

**8-Spectrum Imaging:** Detects a wide range of skin concerns, including pigmentation, acne, and sensitivity

**AI-Powered Analysis:** Rapidly generates precise results, tailored to each client's unique skin profile

**Comprehensive Reporting:** Provides easy-to-read reports for tracking progress over time

**User-Friendly Design:** Intuitive touchscreen interface with quick image capture and analysis



Learn more about Aesthetic Consults information @aesthetic\_consults official account

# How Skin Analyser 3D Works

Using a combination of advanced imaging technology and AI algorithms, the Skin Analyser 3D evaluates a range of skin concerns in real time, providing actionable insights for treatment planning

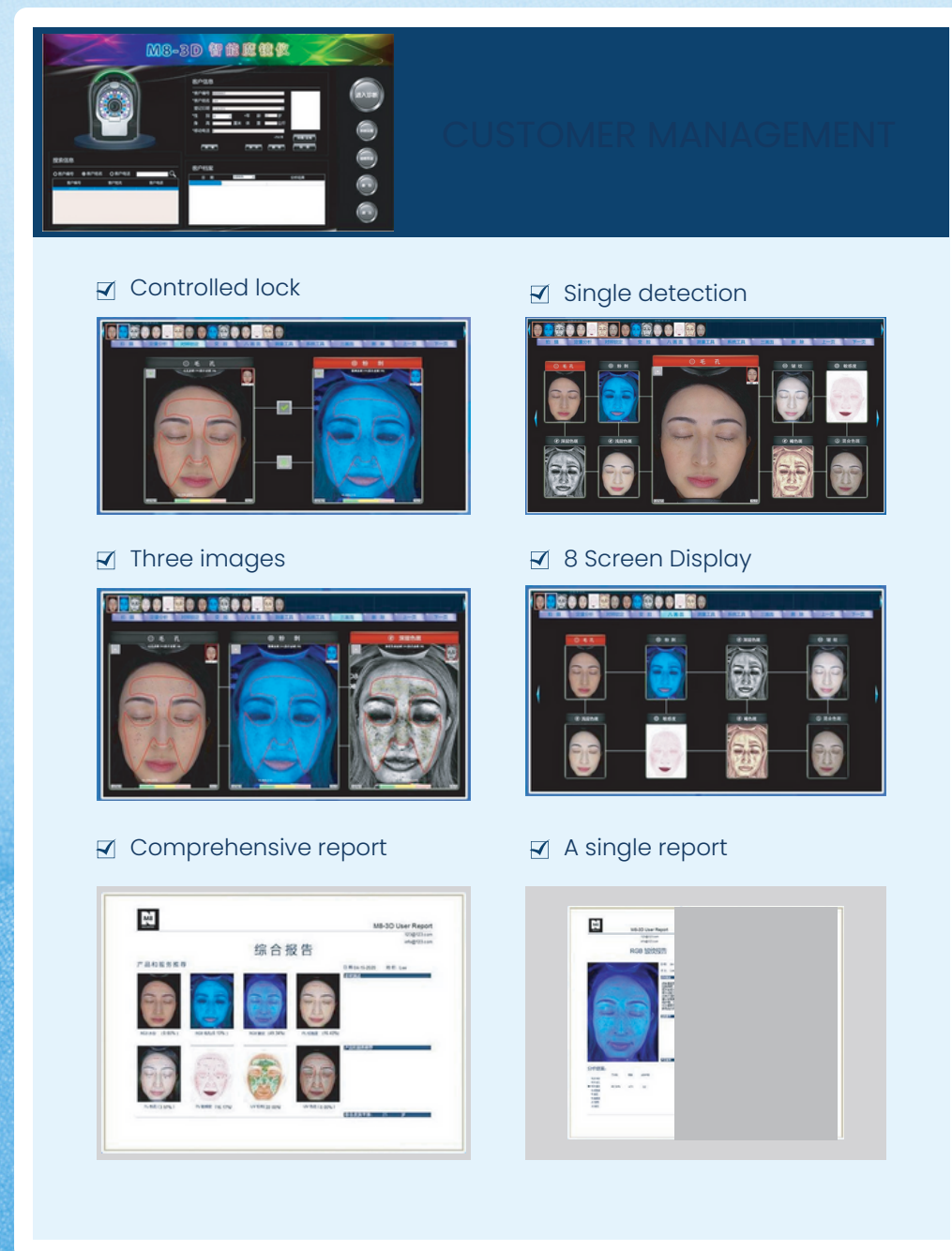

- **3D Face Mapping:** Creates an accurate, high-resolution 3D model of the face for visual analysis
- **8-Spectrum Imaging:** Utilises different light spectrums to detect surface and subsurface concerns
- **AI-Driven Diagnosis:** Processes detailed data to identify issues such as wrinkles, pigmentation, pores, and hydration
- **Customised Reports:** Generates detailed client reports with easy-to-understand visuals and personalised treatment recommendations

## Comprehensive Diagnostic Capabilities

**8-Spectrum Imaging:** The Skin Analyser 3D uses advanced light spectrums to assess various skin concerns

- **White Light:** Analyses surface texture and pore size
- **UV Light:** Highlights clogged pores and acne
- **Polarised Light:** Maps shallow and deep pigmentation
- **Brown Light:** Detects age spots and melasma
- **Oil-Rich Light:** Assesses sebum levels for oily or acne-prone skin
- **Red Light:** Evaluates sensitivity and inflammation
- **Mixed Light:** Measures hydration and moisture levels

**Real-Time 3D Visualisation:** Engage clients with detailed 3D models of their face, allowing them to visualise their concerns and understand the recommended treatments

**Progress Tracking:** Compare results over time with easy-to-read reports that document improvements in wrinkles, pigmentation, and hydration

**Progress Tracking:** Compare results over time with easy-to-read reports that document improvements in wrinkles, pigmentation, and hydration

# Benefits of Adding Skin Analyser 3D to Your Clinic

## For Your Clinic

- **Improve Client Confidence:** Build trust with data-driven, visual evidence of skin concerns
- **Expand Service Offerings:** Combine diagnostics with facials, laser treatments, or skincare plans
- **Boost Retention:** Progress tracking encourages clients to stay committed to their treatment plans
- **Maximise Revenue:** Offer premium diagnostic services and increase client satisfaction

## For Your Patients

- **Customised Treatment Plans:** Tailored recommendations based on detailed skin analysis
- **Engaging Visuals:** Clear and detailed 3D imaging helps clients understand their skin better
- **Trackable Results:** Tangible proof of improvement with each follow-up session
- **Safe and Non-Invasive:** Suitable for all skin types, including sensitive skin



## Device Specifications

- **Camera Resolution:** 20-megapixel high-definition imaging
- **8 Imaging Spectrums:** Detects a wide range of concerns with precision
- **Screen:** Intuitive 15.6-inch colour touchscreen for easy operation
- **Compact Design:** Lightweight and ergonomic (400 x 300 x 350mm, 10kg)
- **Connectivity:** USB and Bluetooth-enabled for seamless integration
- **Report Generation:** Compatible with A4 colour printers for professional reports

## Frequently Asked Questions (FAQ)

A full session takes approximately 15–20 minutes, including imaging and report generation

### Can it track progress over multiple treatments?

Yes, the device provides comparative reports to monitor improvements in real time

### Is it suitable for all skin types?

Absolutely! The Skin Analyser 3D is safe and effective for all skin tones and types

### Do I need special training to operate it?

The device is user-friendly, and we provide comprehensive training to ensure your team is confident using it

### Can the analysis be combined with other treatments?

Yes, it pairs perfectly with facials, chemical peels, laser treatments, and other advanced skincare options